

NATURAL
HISTORY
MUSEUM
LOS ANGELES COUNTY

The Natural History Museum
of Los Angeles County
&
Glendale Community College

GLENDALE
COMMUNITY
COLLEGE

present:

Final Project Presentations of Museum Studies Interns



Friday, December 4, 2015
1:00- 4:00 PM
Times Mirror Room

Note the route to the Times Mirror Room because of the Mummies exhibit

Times Mirror Room marked with a

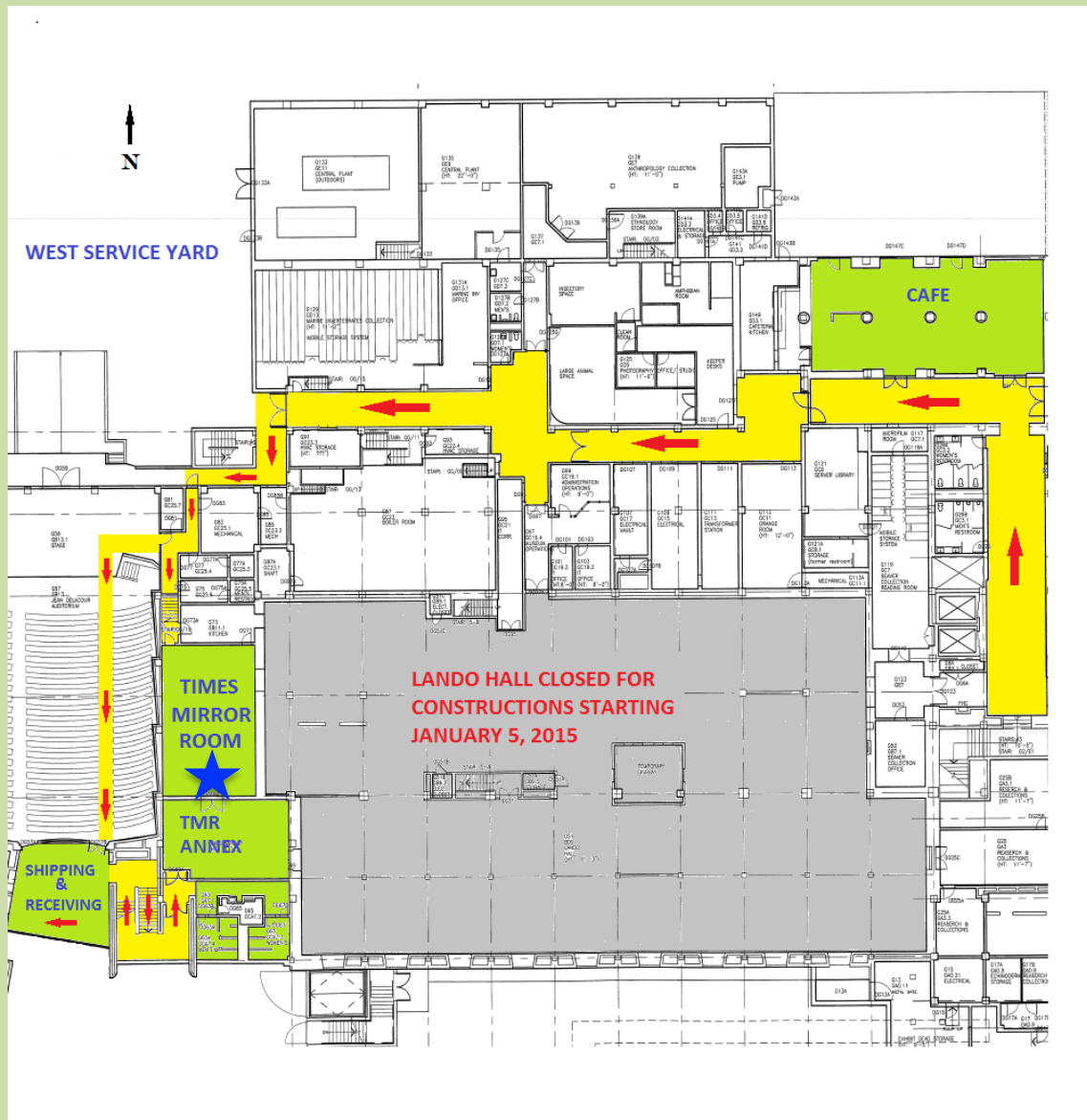

Museum address: 900 Exposition Blvd., Los Angeles, CA 90007
Parking in NHM lot or Lot 3, both on Bill Robertson Blvd.

Please tell the parking attendant and the Museum's guest relations staff that you are a guest of the Museum for the student intern presentations.