



CAREER EDUCATION

Your path to employment

ARCHITECTURAL DRAFTING & DESIGN

(CAREER PATHWAY CHECKLIST –High School & New Students)

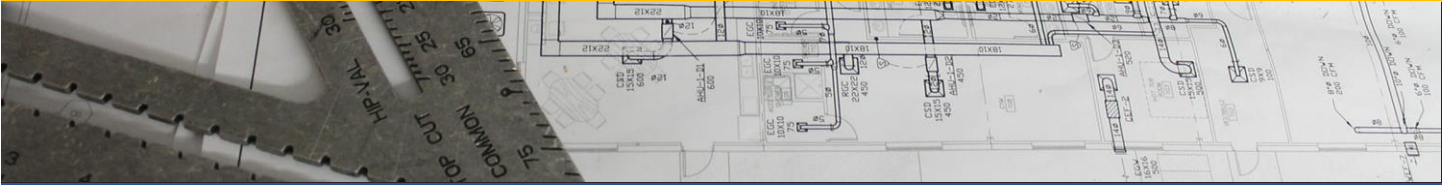

ABOUT THE JOB

Prepare detailed drawings of architectural designs and plans for buildings and structures according to specifications provided by architect.

SAMPLE OF JOB TITLES

Architect, Architectural Designer, Architectural Drafter, Architectural Draftsman, Architectural Intern, CAD Technician (Computer-Aided Design Technician), Drafter, Draftsman, Intern Architect, Project Manager

EDUCATION

- *68% of respondents had a Bachelor’s degree
- *15% of respondents had an Associate’s degree
- *8% of respondents had Some college, or no degree

WAGE & EMPLOYMENT TRENDS

Median wages (2017) \$25.42 hourly, \$52,870 annual
Employment (2016) 100,000 employees
Projected growth (2016-2026) Average (5% to 9%)
Projected job openings (2016-2026) 9,500

TECHNOLOGY SKILLS

Technology Skill— a technology requirement frequently included in employer job postings

- Computer aided design CAD software** —Autodesk AutoCAD; Autodesk Revit
- Development environment software** Adobe Systems Adobe Acrobat
- Graphics or photo imaging software** — Adobe Systems Adobe Illustrator
- Document management software** — Adobe Systems Adobe Acrobat

*all information pulled from O*net Online www.onetonline.org *O*NET database, containing hundreds of standardized and occupation-specific descriptors on almost 1,000 occupations covering the entire U.S. economy. The database, which is available to the public at no cost, is continually updated from input by a broad range of workers in each occupation. WWW.SalarySurfer.CCCCO.edu - provides an estimate on potential wages to be earned after receiving a certificate or degree. / www.CACareerCafe.com is a Virtual Career Center open 24/7 bringing you insights and tools for success.\

ARCHITECTURAL DRAFTING & DESIGN

(CAREER PATHWAY CHECKLIST –High School & New Students)

Skill Award: 9 units each

Certificate, Degree: Total 42 units

FALL SEMESTER 1	CHECK	SPRING SEMESTER 2	CHECK
ARCH 101 Drafting & Basic Design 3.0 Units, Transfer, CSU	<input type="checkbox"/>	ARCH 102 Architectural Drafting & Design 3.0 Units, Transfer Credit, CSU	<input type="checkbox"/>
FALL SEMESTER 3		SPRING SEMESTER 4	
ARCH 250 Introduction to Autodesk Revit Architecture 3.0 Units	<input type="checkbox"/>	ARCH 120 Residential Architectural Design I 3.0 Units, Transfer, CSU	<input type="checkbox"/>
Complete the online petition for your Residential Design Skill Award: Your Skill Award will be mailed to you after reviewing your required courses and grade in the courses (ARCH 101, ARCH 102, & ARCH 120) "C" average is required.			
FALL SEMESTER 5		SPRING SEMESTER 6	
**ENGR 109 Computer Aided Design AutoCAD I 3.0 Units, Transfer, CSU, UC **Note: The class may not be available at the High School campus. Student may take the class at the GCC campus. Meet with your counselor and ask about Jump Start at GCC	<input type="checkbox"/>	**ART 130 2d Foundations 3.0 Units, Transfer, CSU **Note: The class may not be available at the High School campus. Student may take the class at the GCC campus. Meet with your counselor and ask about Jump Start at GCC	<input type="checkbox"/>
College Courses at GCC			
FALL SEMESTER 1		SPRING SEMESTER 2	
ARCH 103 Descriptive Geometry 3.0 Units, Transfer, CSU, UC, USC	<input type="checkbox"/>	ARCH 105 Perspective Graphics 3.0 Units, Transfer, CSU, UC, USC	<input type="checkbox"/>
ARCH 106 Building Codes I 3.0 Units, Transfer Credit, CSU	<input type="checkbox"/>	ARCH 125 Residential Architectural Design II 3.0 Units, Transfer, CSU	<input type="checkbox"/>
*Any College-Level English Class Note: *T ED 140 Fundamentals of Engineering Documentation (3 units) [any College-Level English class]	<input type="checkbox"/>	*Any College-Level Math Class Note: *T ED 142 Technical Mathematics I (3 units) [any College-Level Math class]	<input type="checkbox"/>
Congrats! Complete the online petition for your Visualization Skill Award. Your Skill Award will be mailed to you after reviewing your required courses and grade in the courses (ARCH 101, ARCH 103 & ARCH 105) "C" average is required.			<input type="checkbox"/>
FALL SEMESTER 3		SPRING SEMESTER 4	
ARCH 130 Commercial Architectural Design I 3.0 Units, Transfer, CSU	<input type="checkbox"/>	ARCH 135 Commercial Architectural Design II 3.0 Units, Transfer, CSU	<input type="checkbox"/>
SPCH 101 Interpersonal Communication 3.0 Units, Transfer, CSU, UC, USC or BUSAD 152 Management Communication-Oral 3.0 Units, Transfer, CSU	<input type="checkbox"/>	Congrats! Complete the Petition for Certificate Form and submit form to the Admissions and Records Office	

GRADUATION REQUIREMENTS The requirement for the Associate in Arts/Science degree may be met by completing a Major with a minimum of 18 semester units + GENERAL EDUCATION (GE). A total 60 unit is a requirement for the Associate Degree. **SEE A COUNSELOR TO PREPARE A STUDENT EDUCATIONAL PLAN**

Glendale Community College • www.glendale.edu/CareerEd • 818-240-1000 ext. 5906, 5918, or 5407