



# CAREER EDUCATION

Your path to employment

## ARCHITECTURAL DRAFTING & DESIGN

(CAREER PATHWAY CHECKLIST –High School & New Students)

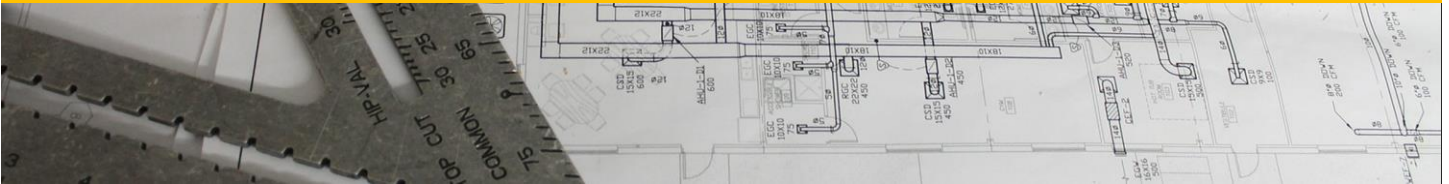

### ABOUT THE JOB

Prepare detailed drawings of architectural designs and plans for buildings and structures according to specifications provided by architect.

### SAMPLE OF JOB TITLES

Architect, Architectural Designer, Architectural Drafter, Architectural Draftsman, Architectural Intern, CAD Technician (Computer-Aided Design Technician), Drafter, Draftsman, Intern Architect, Project Manager

### EDUCATION

- \*68% of respondents had a Bachelor's degree
- \*15% of respondents had an Associate's degree
- \*8% of respondents had Some college, or no degree

### WAGE & EMPLOYMENT TRENDS

**Median wages** (2017) \$25.42 hourly, \$52,870 annual  
**Employment** (2016) 100,000 employees  
**Projected growth** (2016-2026) Average (5% to 9%)  
**Projected job openings** (2016-2026) 9,500

### TECHNOLOGY SKILLS

Technology Skill— a technology requirement frequently included in employer job postings

**Computer aided design CAD software** —Autodesk AutoCAD; Autodesk Revit  
**Development environment software** Adobe Systems Adobe Acrobat  
**Graphics or photo imaging software** — Adobe Systems Adobe Illustrator  
**Document management software** — Adobe Systems Adobe Acrobat

\*all information pulled from O\*net Online [www.onetonline.org](http://www.onetonline.org), O\*NET database, containing hundreds of standardized and occupation-specific descriptors on almost 1,000 occupations covering the entire U.S. economy. The database, which is available to the public at no cost, is continually updated from input by a broad range of workers in each occupation. [www.SalarySurfer.CCCCO.edu](http://www.SalarySurfer.CCCCO.edu) - provides an estimate on potential wages to be earned after receiving a certificate or degree. / [www.CACareerCafe.com](http://www.CACareerCafe.com) is a Virtual Career Center open 24/7 bringing you insights and tools for success.\

Glendale Community College • [www.glendale.edu/CareerEd](http://www.glendale.edu/CareerEd) • 818-240-1000 ext. 5906, 5918, or 5407

# ARCHITECTURAL DRAFTING & DESIGN

(CAREER PATHWAY CHECKLIST –High School & New Students)

Skill Award: 9 units each

Certificate, Degree: Total 42 units

FALL SEMESTER 1	CHECK	SPRING SEMESTER 2	CHECK
<b>ARCH 101</b> Drafting & Basic Design 3.0 Units, Transfer, CSU	<input type="checkbox"/>	<b>ARCH 102</b> Architectural Drafting & Design 3.0 Units, Transfer Credit, CSU	<input type="checkbox"/>
<b>FALL SEMESTER 3</b>		<b>SPRING SEMESTER 4</b>	
<b>ARCH 250</b> Introduction to Autodesk Revit Architecture 3.0 Units	<input type="checkbox"/>	<b>ARCH 120</b> Residential Architectural Design I 3.0 Units, Transfer, CSU	<input type="checkbox"/>
Complete the <a href="#">online petition</a> for your Residential Design Skill Award: Your Skill Award will be mailed to you after reviewing your required courses and grade in the courses (ARCH 101, ARCH 102, & ARCH 120) "C" average is required.			
FALL SEMESTER 5	CHECK	SPRING SEMESTER 6	CHECK
<b>**ENGR 109</b> Computer Aided Design AutoCAD I 3.0 Units, Transfer, CSU, UC  <b>**Note:</b> The class may not be available at the High School campus. Student may take the class at the GCC campus. Meet with your counselor and ask about <a href="#">Jump Start at GCC</a>	<input type="checkbox"/>	<b>**ART 130</b> 2d Foundations 3.0 Units, Transfer, CSU  <b>**Note:</b> The class may not be available at the High School campus. Student may take the class at the GCC campus. Meet with your counselor and ask about <a href="#">Jump Start at GCC</a>	<input type="checkbox"/>
<b>College Courses at GCC</b>			
FALL SEMESTER 1	CHECK	SPRING SEMESTER 2	CHECK
<b>ARCH 103</b> Descriptive Geometry 3.0 Units, Transfer, CSU, UC, USC	<input type="checkbox"/>	<b>ARCH 105</b> Perspective Graphics 3.0 Units, Transfer, CSU, UC, USC	<input type="checkbox"/>
<b>ARCH 106</b> Building Codes I 3.0 Units, Transfer Credit, CSU	<input type="checkbox"/>	<b>ARCH 125</b> Residential Architectural Design II 3.0 Units, Transfer, CSU	<input type="checkbox"/>
<b>*Any College-Level English Class</b> Note: *T ED 140 Fundamentals of Engineering Documentation (3 units) [any College-Level English class]	<input type="checkbox"/>	<b>*Any College-Level Math Class</b> Note: *T ED 142 Technical Mathematics I (3 units) [any College-Level Math class]	<input type="checkbox"/>
Congrats! Complete the <a href="#">online petition</a> for your Visualization Skill Award. Your Skill Award will be mailed to you after reviewing your required courses and grade in the courses (ARCH 101, ARCH 103 & ARCH 105) "C" average is required.			<input type="checkbox"/>
<b>FALL SEMESTER 3</b>		<b>SPRING SEMESTER 4</b>	
<b>ARCH 130</b> Commercial Architectural Design I 3.0 Units, Transfer, CSU	<input type="checkbox"/>	<b>ARCH 135</b> Commercial Architectural Design II 3.0 Units, Transfer, CSU	<input type="checkbox"/>
<b>SPCH 101</b> Interpersonal Communication 3.0 Units, Transfer, CSU, UC, USC or <b>BUSAD 152</b> Management Communication-Oral 3.0 Units, Transfer, CSU	<input type="checkbox"/>	Congrats! Complete the <a href="#">Petition for Certificate Form</a> and submit form to the Admissions and Records Office	<input type="checkbox"/>

GRADUATION REQUIREMENTS The requirement for the Associate in Arts/Science degree may be met by completing a Major with a minimum of 18 semester units + GENERAL EDUCATION (GE). A total 60 unit is a requirement for the Associate Degree. SEE A COUNSELOR TO PREPARE A STUDENT EDUCATIONAL PLAN

Glendale Community College • [www.glendale.edu/CareerEd](http://www.glendale.edu/CareerEd) • 818-240-1000 ext. 5906, 5918, or 5407